

Citizen's Park

Troy Hill Civic Association
Design Center
Origin 4 Design

Citizens Park Redesign – Troy Hill

The Design Center awarded Troy Hill Citizens (THC) a \$15,000 grant for the redesign of Citizens Park. Citizens Park is the heart of the Troy Hill neighborhood. Design plans were previously prepared, but those plans were not able to be implemented due to the cost.

The Design Center believed that the redesign and implementation of this park would have a great community impact. The restriction of use in Citizens Park was due to large boulders lining the center of the park, this was a source of conflict for residents. The community envisioned an open and flexible space for multiple activities as well as large community gatherings. The steering committee selected a young landscape architecture firm, which echoed the community's desire for the need of creating a flexible space.

Community input was gathered by the landscape architects and Design Center staff at the Troy Hill community festival. Changes that reflected community feedback were incorporated in the final design plans before being presented at the final public meeting. The final plan created an open space that could be activated by various uses. The plan removed the boulders from the center and placed them to the side of the stage for seating purposes. Other elements included an elevated staged, seating around the edges, planting at each entrance, natural play area and linear lines that are visually appealing.

The Department of Public Works (DPW) supported this project by completing the construction and implementation. Councilwoman Harris also supported this project. On September 19th 2014, THC had a ribbon cutting and celebration event. Over 250 residents and stakeholders attended.



Prepared by:
Origin 4Design
 443 S. Atlantic Avenue
 Pittsburgh, PA 15224

Prepared for:
Troy Hill Citizens Inc.

Date: 2 July 2013

Citizens' Park
PERSPECTIVE SKETCH



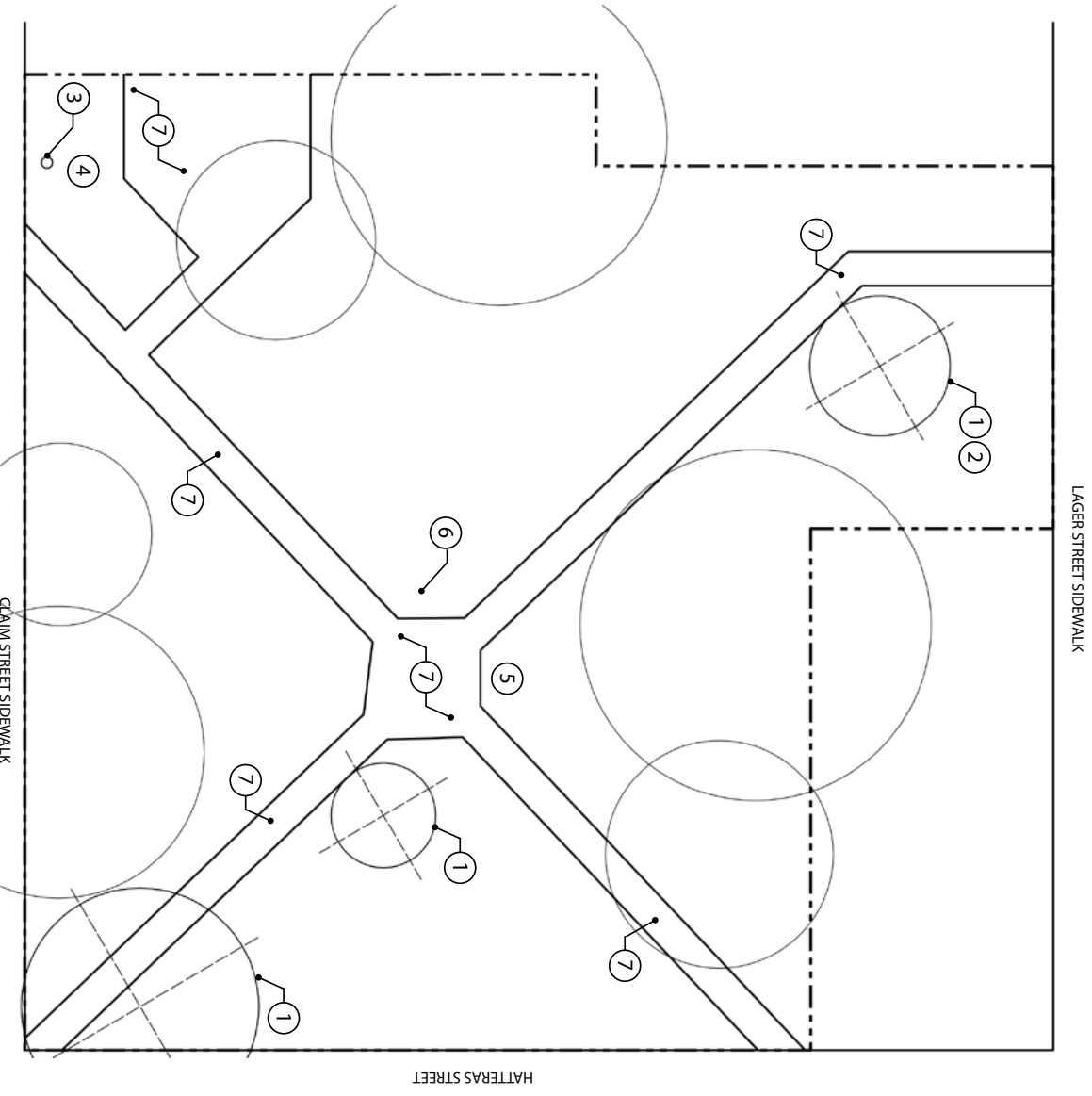

LAGER STREET SIDEWALK

HATTERAS STREET

CLAIM STREET SIDEWALK

DEMOLITION PLAN NOTES:

1. THIS DRAWING HAS BEEN CREATED FOR THE PURPOSES OF CONVEYING DESIGN INTENT TO CITY OF PITTSBURGH PUBLIC WORKS. FOR IMPROVEMENTS CARRIED OUT BY PUBLIC WORKS, SURVEY INFORMATION WAS NOT AVAILABLE, AND EXISTING CONDITIONS ARE BASED UPON AERIAL PHOTOGRAPHY AND FIELD MEASUREMENTS. ALL CONDITIONS SHOULD BE FIELD VERIFIED.
2. PROTECT TO TREES TO REMAIN DURING CONSTRUCTION OPERATIONS. MINIMIZE THE DRIVING OF MACHINERY OVER ROOT AREAS. PROTECT TRUNK FROM DAMAGE. FOR EXISTING TREES TO REMAIN, CITY URBAN FORESTER WILL ARRANGE CONTRACT WITH PROFESSIONAL ARBORIST FOR PRUNING AND REMOVAL OF LOW BRANCHES.
3. MOVE BENCHES TO LOCATIONS AT THE PERIMETER SIDEWALK AND AWAY FROM CONSTRUCTION ACTIVITY.
4. MOVE EXISTING STONES TO TEMPORARY ON-SITE STAGING AREAS AWAY FROM CONSTRUCTION ACTIVITY.

DEMOLITION PLAN KEYNOTES:

- ① TREE TO BE REMOVED.
- ② PRIOR TO REMOVAL OF EVERGREEN, VERIFY IF CITY CAN USE FOR "CHRISTMAS TREE".
- ③ EXISTING UTILITY POLE AND ELECTRIC SERVICE TO REMAIN. PROTECT.
- ④ LOCATION OF EXISTING METAL SCULPTURE. THE SCULPTURE IS INTENDED TO BE RELOCATED OFF SITE. IF SCULPTURE REMAINS ON SITE AT TIME OF CONSTRUCTION, PROTECT. DELAY CONSTRUCTION OF RAISED BED IN THIS AREA.
- ⑤ EXISTING HOSE BIB TO BE RELOCATED UNDERGROUND
- ⑥ FLAG POLE TO BE RELOCATED.
- ⑦ REMOVE ASPHALT.



**Troy Hill Citizens Park
Demolition Plan**

Prepared by:
Origin4Design
443 S. Atlantic Avenue
Pittsburgh, PA 15224

Prepared for:
City of Pittsburgh
Public Works



Prepared by:
Origin 4Design
 443 S. Atlantic Avenue
 Pittsburgh, PA 15224

Prepared for:
Troy Hill Citizens Inc.

Date: 2 July 2013

Citizens' Park
PERSPECTIVE SKETCH

